

### 3. TYPICAL SIGN BALLAST AWM 1015 VW-I WIRING INSTALLATION

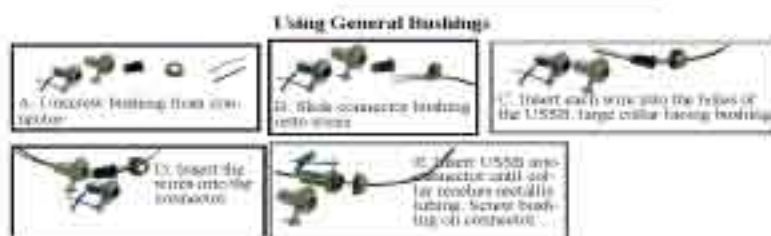

**Fig. 6** When using USSB with standard sign ballast AWM 1015 VW wire, there is no need of cutting the USSB. Simply use a drill of 5/32" maximum to perforate the second hole at bottom.



**Fig. 7** You may use ElectroBis Passthru, General bushings or Straits connectors with USSB and GE TETRA led wiring.

#### Using Straits Connector



#### Using General Bushings



#### Using Passthru



### 4. TYPICAL NEON GTO WIRE & 3730 GOTOSLEEVING INSTALLATION

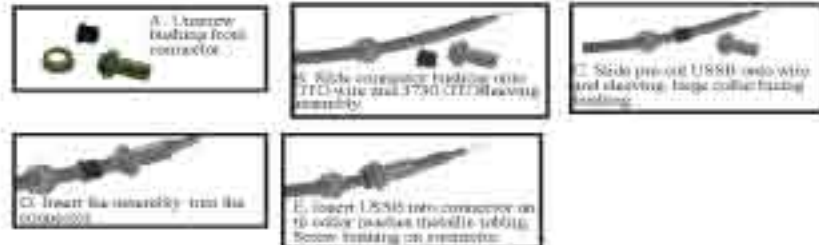

**Fig. 8 & 9** When using USSB with GTO wire and 3730 GOTOSLEEVING, you must cut the USSB along the 2nd ribbed line (distance) to remove the two first sections of the bushing (the ones with the two small holes). Make sure to grasp the flanged end of the USSB prior to cutting to reduce the likely hood the piece the you need to keep would fall to the ground.



**Fig. 10** You may use ElectroBis Passthru, General bushings or Straits connectors with USSB and GTO wire and 3730 GOTOSLEEVING assembly.

#### Using Straits Connector



#### Using General Bushings



#### Using Passthru

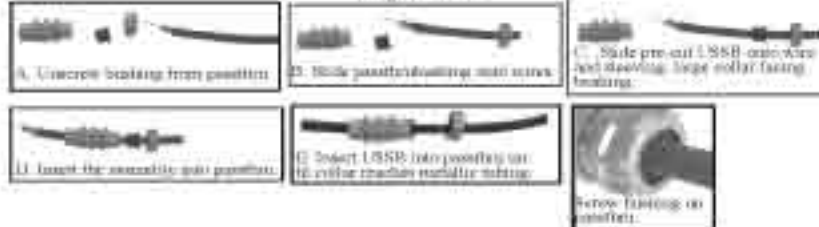

### 5. TYPICAL NEON GTO WIRE & WB3760 WET GOTOSLEEVING INSTALLATION

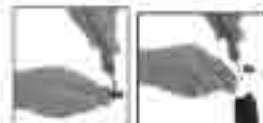
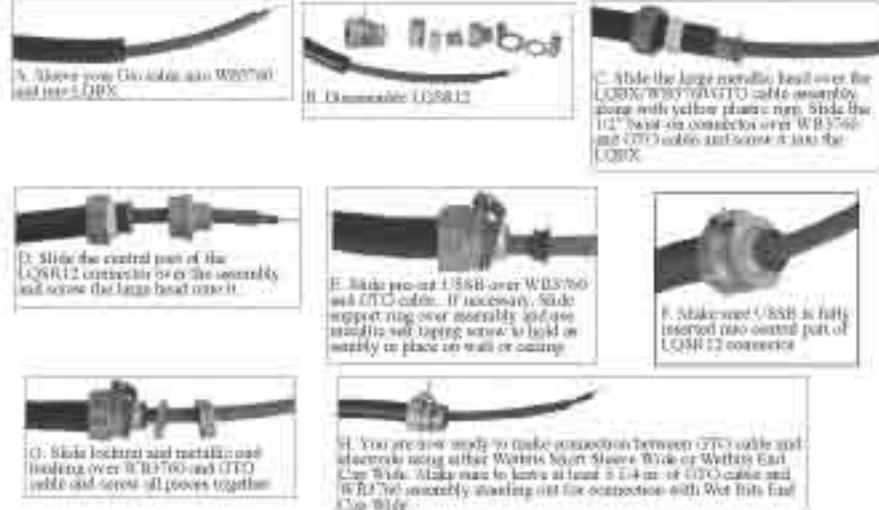

**Fig. 11 & 12** When using USSB with GTO wire and WB3760 WET GOTOSLEEVING, you must cut the USSB between the 2nd ribbed line (distance) to remove the three first sections of the bushing. Keeping only the bottom part with the flanged collar. Make sure to grasp the flanged end of the USSB prior to cutting to reduce the likely hood the piece the you need to keep would fall to the ground.



**Fig. 13** You may use ElectroBis OUTPUT and Liquid Tight connector with USSB and GTO wire and 3760 WET GOTOSLEEVING assembly.

#### Using LQSR12 Liquid Tight connector



#### Using OUTPUT

