

# Passthru and Outdoor Passthru Installation instructions using USSB

## GENERAL WARNINGS AND INSTRUCTIONS



USSB stands for UNIVERSAL SIGN SEALING BUSHING. It is designed to fit all Electrobits® connectors: Passthru (any length), Straight Connectors Male, General Binding (all models) and Liquid Tight connectors. It is also designed to receive safely any type of secondary sign wire: GTO wire for neon signs, GF Tetra or Standard wires for LED signs as well as ballast wire for fluorescent signs.  
**RATING: 1500V midpoint grounded.**  
 Do not cut or modify otherwise than as per proper instructions. Always use a diagonal cutter or similar tool to insure a clean cut of USSB.

Electrobits® USSB is to be installed as part of UL listed, recognized or classified system; it does not constitute UL installation by itself. The following pages present the 6 different types of wiring you may use with Electrobits® USSB and the 6 different connectors. Always follow the appropriate installation instructions.

### 1. TYPICAL LED SIGN RV-ANYH WIRING / Dry and Damp Locations

**Fig. 1** When using USSB with standard LED wire, there is no need of cutting the bushing. Simply use a drill of 5/32" maximum to perforate the second hole at bottom.

#### Using Passthru

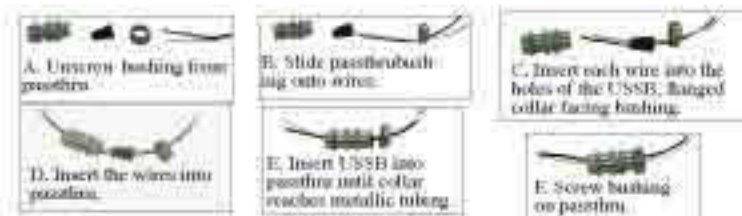

### 2. TYPICAL LED GE TETRA WIRING INSTALLATION / Dry and Damp Locations

**Fig. 2** When using USSB with GE TETRA LED wire, you must cut the USSB along the 1st molded line delimitation to remove the first section with the two holes. Make sure to grasp the flanged end of the USSB prior to cutting to reduce the likely hood that the piece you need to keep would fall to the ground.

#### Using Passthru

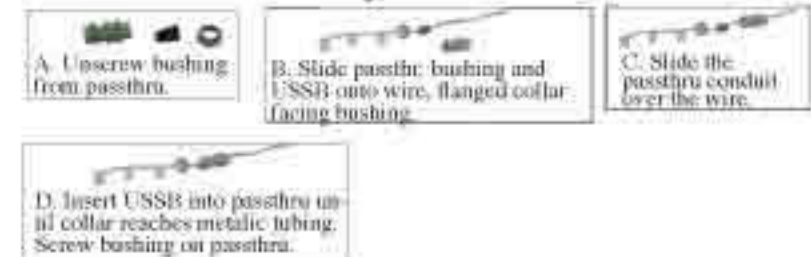

### 3. TYPICAL SIGN BALLAST ANYH-ANYH WIRING INSTALLATION / Dry and Damp Locations

**Fig. 3** When using USSB with standard sign ballast ANYH-ANYH wire there is no need of cutting the USSB. Simply use a drill of 5/32" maximum to perforate the second hole at bottom.

#### Using Passthru

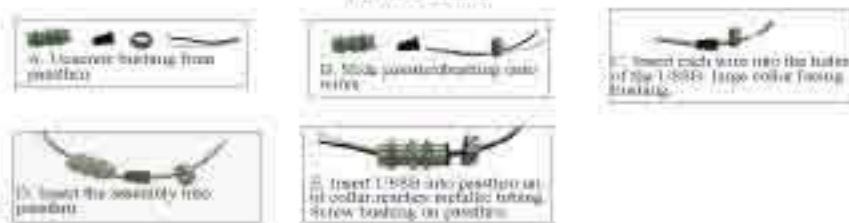

### 4. TYPICAL NEON GTO WIRE & GTO GTO SLEEVING INSTALLATION / Dry, Damp and wet locations

**Fig. 4 & 5** When using USSB with GTO wire and GTO GTO SLEEVING, you must cut the USSB along the 2nd rib to remove the two first sections of the bushing (the ones with the two small holes). Make sure to grasp the flanged end of the USSB prior to cutting to reduce the likely hood that the piece you need to keep would fall to the ground.

#### Using Passthru

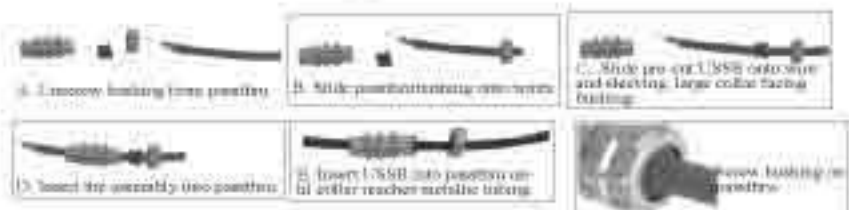

### 5. TYPICAL NEON GTO WIRE & WB3760 GTO SLEEVING INSTALLATION / Dry, Damp and wet locations

**Fig. 6 & 7** When using USSB with GTO wire and WB3760 GTO SLEEVING, you must cut the USSB between the 2nd molded line delimitation to remove the first two sections of the bushing. Keeping only the bottom part with the flanged collar. Make sure to grasp the flanged end of the USSB prior to cutting to reduce the likely hood that the piece you need to keep would fall to the ground.



### 6. TYPICAL NEON INTEGRAL SLEEVE & GTO CABLE ADAPTOR INSTALLATION / Dry, damp and wet locations

**Fig. 6 & 7** When using USSB with integral sleeve and GTO Cable Adaptor you must cut the USSB between the 2nd molded line delimitation to remove the first two sections of the bushing. Keeping only the bottom part with the flanged collar. Make sure to grasp the flanged end of the USSB prior to cutting to reduce the likely hood that the piece you need to keep would fall to the ground.



- 1- Choose GTOCA according to your GTO cable guide diameter:  
 1.1 For cables O.D. ranging from 0.260" to 0.275" (GTO15 and Integral sleeve GTO), use GTOCA260 as is.  
 1.2 For cables O.D. ranging from 0.300" to 0.315" (Integral sleeve GTO15), you must cut the GTOCA along the parting line, as per figures below.  
 1.3 For GTO cables O.D. ranging from 0.130" to 0.150" (GTO5) use GTOCA130 as is.  
 1.4 For GTO cables O.D. ranging from 0.210" to 0.230" (GTO10), you must cut the GTOCA along the parting line, as per figures below.



- A. Dissassemble the metallic bushing, the USSB and two locknuts from OUTPUT. Maximum length of Flexible Metallic Conduit such as RFL / Integral sleeve GTO cable assembly is 30 feet. Cut 8.6" shorter than integral sleeve GTO cable.  
 B. Insert the integral sleeve GTO cable into the flexible metallic conduit. Use female straight connector (SCF52) to link with OUTPUT. Make sure OUTPUT length covers the wall completely and stands out front for 10". Install OUTPUT thru wall making 1/8" whole. Use provided locknuts to secure in place.  
 C. Slide integral sleeve GTO cable into the OUTPUT. Make sure you have 6" of this assembly standing out front for electrode connection.



- D. Slide the pre-cut USSB and the appropriated GTOCA onto the standing out integral sleeve part of the GTOCA into the USSB, as shown on pictures below.  
 E. To resume installation, slide the metallic bushing over the GTO cable and WB3760 assembly.

